

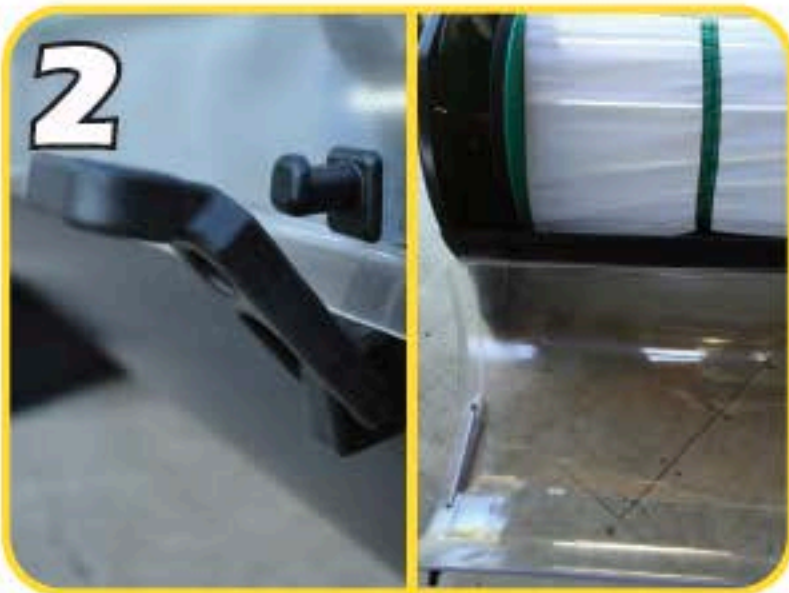

THE ORIGINAL RESINATOR Instruction Manual



Open Lid by unlatching black rubber fasteners.



Unlatch two black rubber fasteners for use of hinge system.

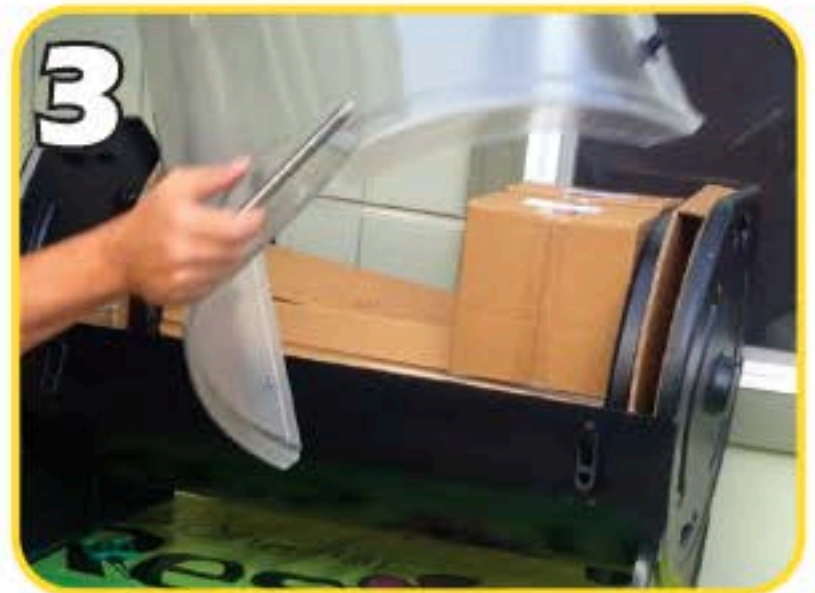

Unlatch all four fasteners to remove lid/workstation.

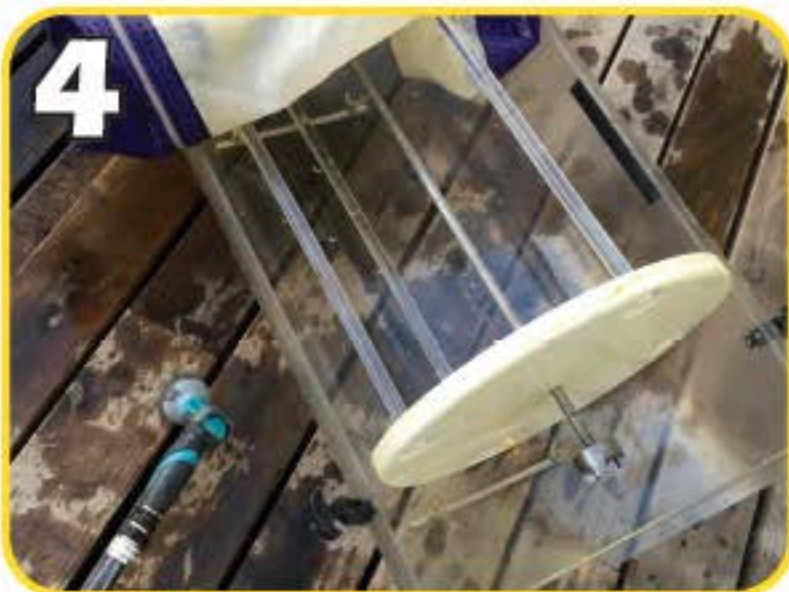

Place lid upside down on handles to function as independent containment free work station

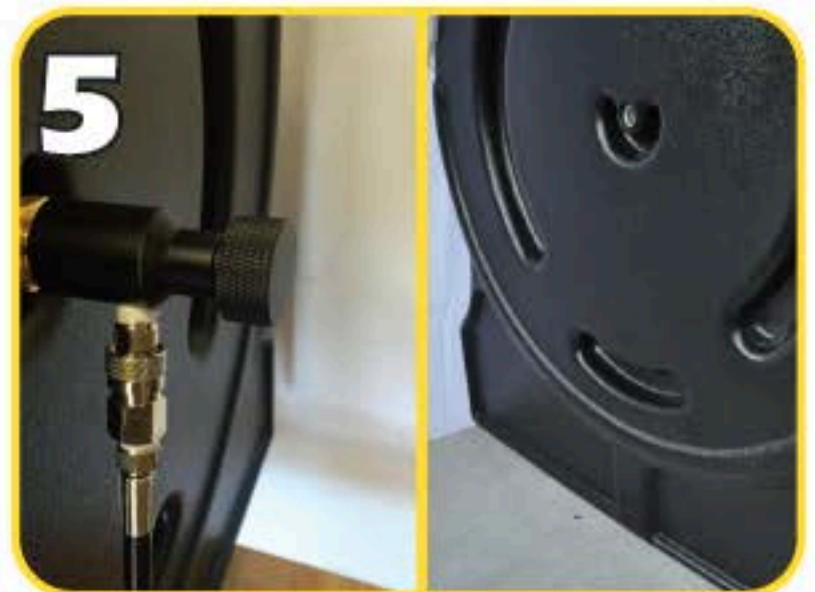

**Before removing drum, be sure to detach any hose accessories.
(See step 16 on how to insert drum.)**



6

To REMOVE drum:
With one hand, lift drum away from motor side first. Then place other hand on alternate side of drum while simultaneously lifting up and away.



7

Before installing screen to drum, clean all surfaces of drum components and Resinator chamber.

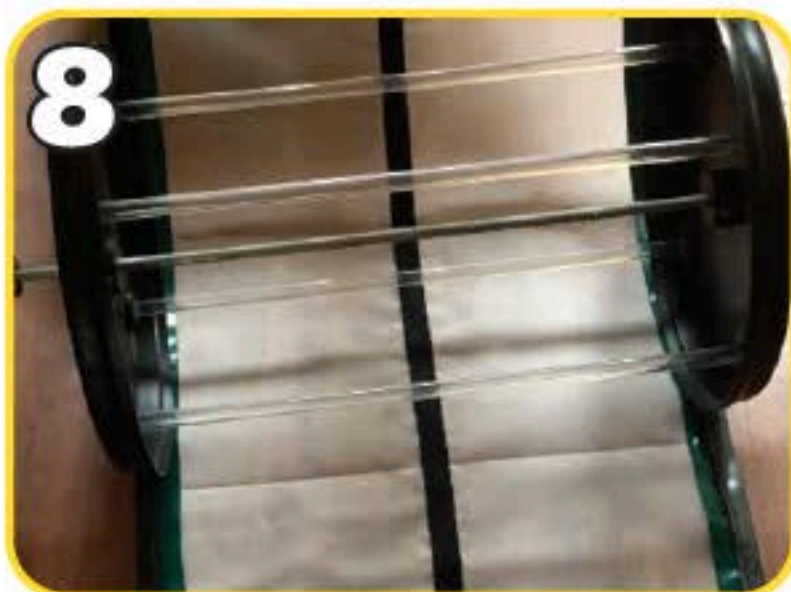

8

Place drum screen flat on ground with the rubber side facing up. Then place drum onto drum screen to align edges.

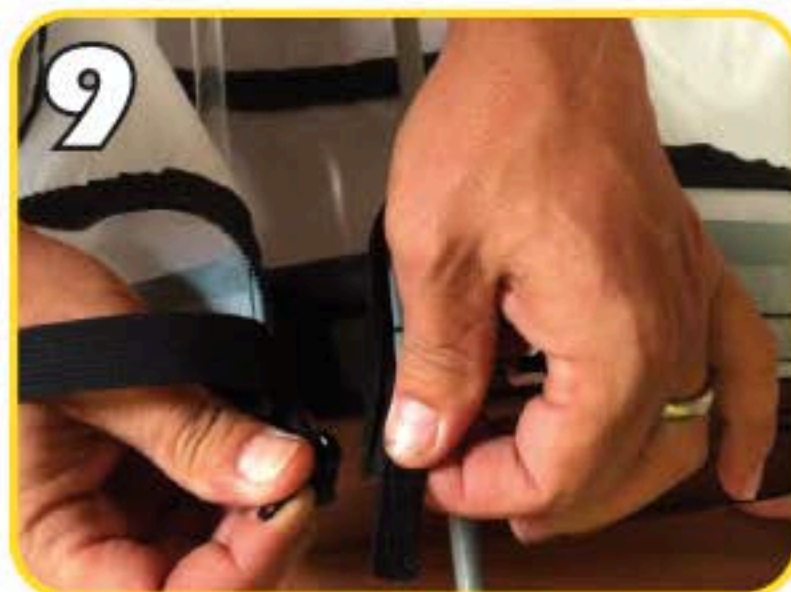

9

Attach screen by carefully wrapping rubber edges of screen flush around drum rim. Connect installation zipper tab to corresponding side.



10

Firmly slide zipper across drum until it stops.



11

1 & 2 -Place nylon strap through metal clip. 3 -Hand tighten by firmly pulling strap to apply tension. 4 -Place loose end of nylon strap into elastic loop. Repeat on alternate side.



**Weigh/Measure desired amount of material.
(SEE EXTRACTION GUIDE)**



**Load Material by unzipping secondary/loading zipper to open position. Place entire bag into drum cylinder and carefully empty contents into drum while removing bag.
*or use hand scoop to load material**



**Apply agitation (balls, dry-ice, or ice) depending on extraction method, to drum interior with material.
(See extraction guide)
*Remove between loads for reuse.
*Not necessary in wet operation.**



Before inserting drum, wipe clean all surfaces of interior chamber. Place appropriate plugs in chamber bottom drain holes (unless using carbon filter.) Place spider into coupler. *All necessary



**To Insert DRUM: Carefully place jaw couplers together by gliding in toward each other at a slight angle to align coupler teeth.
*Spider must inserted between couplers for operation.**



Gently place rotary/quick release side of drum shaft into receiving groove.



CO2- Attach coil hose by inserting quickcoupler plug (through external side port) into quick coupler body (attached to drum shaft). Screw coil nipple/nut to CO2 tank and tighten. Adhere thermometer to lid & place probe into chamber for temp observation. Use stopwatch to time. (See extraction guide) *Agitation recommended *Use manual regulation of CO2 valve to control pressure/PSI. *Connect bungee cord to one side handle & then under chamber base to connect to alternate side handle (not pictured) to minimize leakage. *Use liquid gas in a well ventilated area.



H2O- Add adequate ice. (Should go in with material.) Fill with water to water line on chamber sides. (Just above lower drum rods.) Use stopwatch for to time. (See extraction guide) *Agitation not necessary *Do not get motor wet or leave outside in rain.



Dry-ice- Add adequate dry-ice. (Should go in with material.) Use stopwatch to time. (See extraction guide) *Agitation recommended. *Use gloves when handling dry-ice.



Close loading zipper by pulling zipper tab toward installation zipper. (zipper is self locking) Double check that straps are fastened securely.



Before installing lid/workstation, wipe clean all interior surfaces of lid area. Place lid on machine.



Once lid is securely in place, latch rubber fasteners. See extraction guide for suggested run times, speeds & load sizes. Once batch is completed, utilize collection toolsto aid in collection process. Clean and repeat.

Check out our Instructional Video online.